



GATEWAY SEATING

Designed by Dorsey Cox



Specifications **GATEWAY SEATING**

- Seat / Back:** Self-skinning, molded polyurethane (PU) over steel frame, standard color is black
- Arms:** Die-cast aluminum, open end, standard finish is polished aluminum
- Legs:** Die-cast aluminum, adjustable glide with floor mounting option, standard finish is polished
- Beam:** Extruded aluminum, hex shape, standard length is all arms and color is metallic silver
- Finish:** Electro-static powder coating, standard color is metallic silver
- Frame:** Die-cast aluminum brackets, standard finish is metallic silver
- Table:** High pressure laminate, standard color is black
- Configurations:** Available in 2, 3, 4, and 5-seat units, back-to-back, end-to-end, and cluster
- Options:** Metal color options, PU colors (MOQ), power changing, PRM (handicap), tables, floor mounting

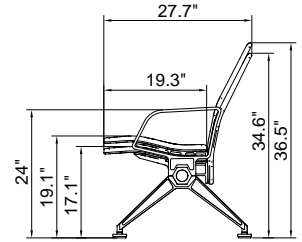

PRM Profile

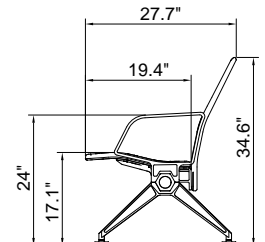

Standard Profile

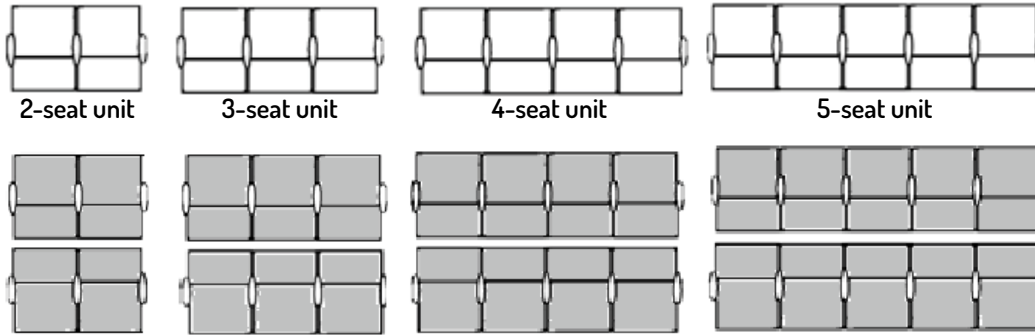

Back-to-back Configurations

Inches	No Arms	End Arms	All Arms
2-seat unit	42.00	46.60	48.10
3-seat unit	63.30	68.00	71.50
4-seat unit	84.70	89.30	93.80
5-seat unit	106.00	110.60	116.60



Metallic Silver
Smooth



Gray
Textured



Charcoal
Textured



Black
Smooth



For assistance with power options and layouts contact:
 Tel: +1-901-685-8263 | Fax: +1-901-683-6745
 Toll Free: +1-800-810-4231
 e-mail: sales@airportseatingalliance.com
www.AirportSeatingAlliance.com