

GATEWAY SEATING

Designed by Dorsey Cox



Gateway Upholstered



Gateway Non-Upholstered

Specifications **GATEWAY SEATING**

- Seat / Back:** 3.0 mm pan, cold rolled steel, perforated, standard color is metallic silver
- Arms:** Die-cast aluminum, open end, standard finish is polished aluminum
- Legs:** Die-cast aluminum, adjustable glide with floor mounting option, standard finish is polished
- Beam:** Extruded aluminum, hex shape, standard length is all arms and color is metallic silver
- Finish:** Electro-static powder coating, standard color is metallic silver
- Frame:** Die-cast aluminum brackets, standard finish is metallic silver
- Cushion:** 20 mm thick, commercial grade A vinyl, standard color is black
- Table:** High pressure laminate, standard color is black
- Configurations:** Available in 2, 3, 4, and 5-seat units, back-to-back, end-to-end, and cluster
- Options:** Metal Color Options, with or without padding, vinyl color options (including COM), power charging, PRM (handicap), tables, floor mounting

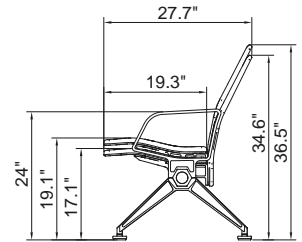

PRM Profile

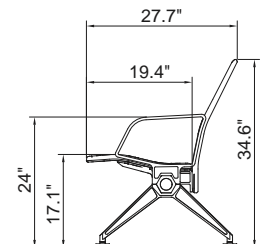

Standard Profile

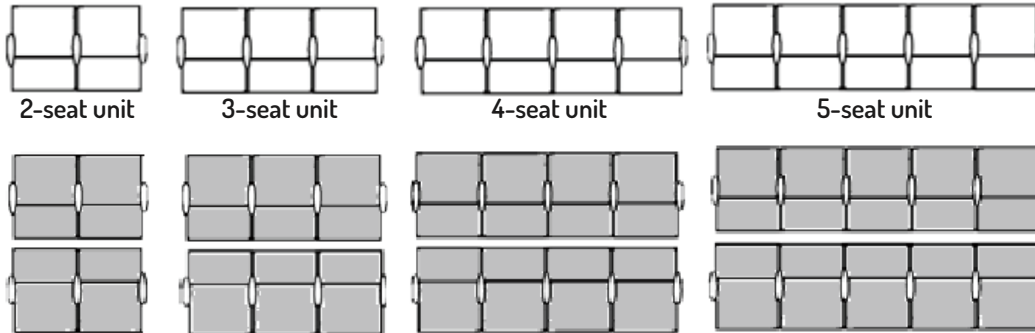

Back-to-back Configurations

Inches	No Arms	End Arms	All Arms
2-seat unit	42.00	46.60	48.10
3-seat unit	63.30	68.00	71.50
4-seat unit	84.70	89.30	93.80
5-seat unit	106.00	110.60	116.60



Back-to-Back



**Metallic Silver
Smooth**



**Gray
Textured**

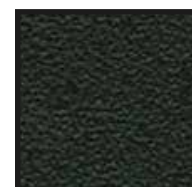

**Charcoal
Textured**



**Black
Smooth**



For assistance with power options and layouts contact:
 Tel: +1-901-685-8263 | Fax: +1-901-683-6745
 Toll Free: +1-800-810-4231
 e-mail: sales@airportseatingalliance.com
www.AirportSeatingAlliance.com